

MILL-TURN

RUN WITH CONFIDENCE; PROGRAM WITH EASE

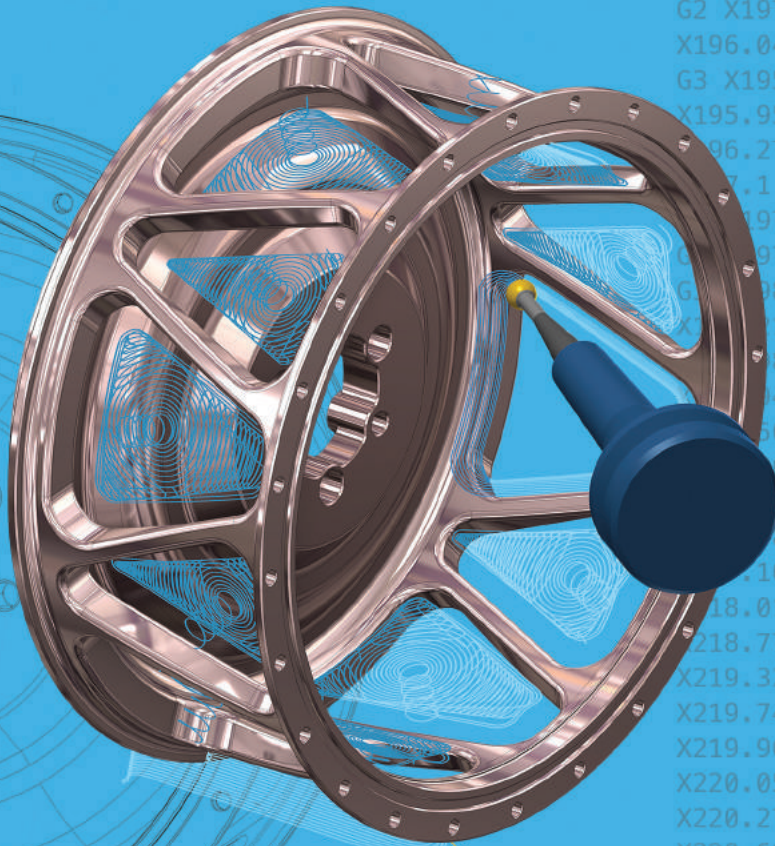

Automate your complex programs on today's high-powered, multitasking machining centers. Program it right the first time, every time.

Mastercam

POWERED BY MASTERCAM'S
DYNAMIC MOTION™ TECHNOLOGY



X221.338 Z-4.120
X221.238 Z-3.688
X220.843 Z-3.228
X220.22 Z-2.781
X218.97 Z-2.208
X217.515 Z-1.771
X216.49 Z-1.407
X213.029 Z-1.144
X209.198 Z-.95
X199.174 Z-.62
G3 X198.73 Z-.811 I.003 K.83
X198.326 Z-.744 I.223 K.803
X198.057 Z-.644 I.427 K.716
G2 X197.714 Z-.502 I-1.605 K-
X196.048 Z-.082 I-1.467 K-1.8
G3 X195.436 Z.319 I.111 K.402
X195.953 Z.705 I.417 K0.
X196.27 Z.736 I.158 K-.385
X197.1 Z.356 I0. K-.417
X197.186 Z-.133
X197.544 Z-.44 I.415 K.036
G3 X198.066 Z-.648 I-1.349 K-
X197.14 Z-.719 I-1.61 K-1.75
X198.513 Z-.868
X197.41 Z-.95
X196.69 Z-1.105
X196.66 Z-1.339
X196.62 Z-1.586
X196.89 Z-1.903
X196.168 Z-2.527
X198.01 Z-3.251
X218.77 Z-4.254
X219.326 Z-5.493
X219.74 Z-7.397
X219.96 Z-11.039
X220.051 Z-101.7
X220.279 Z-104.72
X220.687 Z-106.299
X221.086 Z-107.059
G2 X221.281 Z-107.259 I.791 K
X221.574 Z-107.426 I.694 K.46
X221.945 Z-107.548 I.548 K.62
X222.039 Z-107.569 I.362 K.75
G3 X222.443 Z-107.663 I-.901
X223.909 Z-108.232 I-1.066 K-
G2 X224.538 Z-108.376 I.315 K
X225.7959 I0. K.417
X225.37 Z-107.936 I-.417 K0.
X224.538 Z-107.542 I-.416 K-
X224.232 Z-107.571 I0. K-.417
G1 X223.361 Z-107.744
Z-107.773 I-.153
X220.716 I0. K.417
Z-107.569 I-1.199
X220.494 I-.899 K-2
X221.414 Z-107.466 I-.689 K-2
G1 X220.903 Z-107.281
X220.208 Z-106.799



SIMPLIFY YOUR MOST COMPLICATED PROJECTS

Mastercam Mill-Turn simplifies today's high-powered, multistream machining centers.

With Mastercam, your workflow is efficient. Choose your machine, and Mastercam Mill-Turn automates part transfers, toolplanes, stock definition, and setup. Then apply your toolpaths and launch the Sync Manager, verify your project with simulation, and post your code. Changes along the way are fast and easy — the way programming should be.

Mill-Turn's Sync Manager is a user-friendly way to optimize part cycle times and manage interactions between toolpath operations. Easily navigate our Gantt-style timeline and vertical stream interface to coordinate operations and track cycle times.

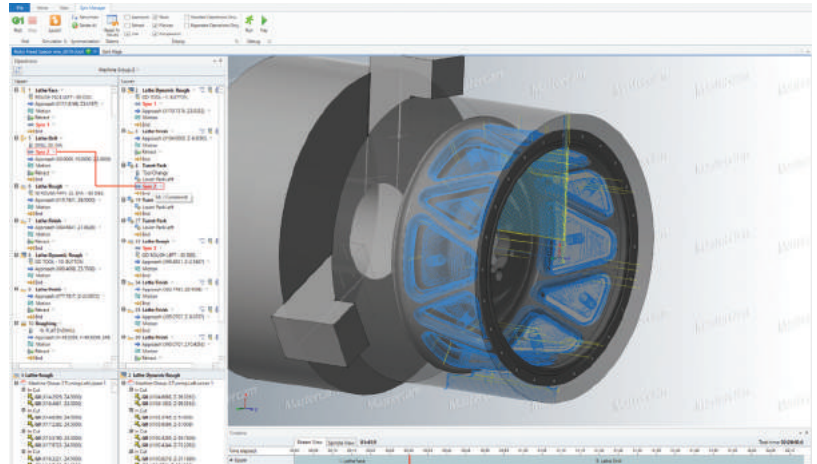

Get more out of your machines with Machine Simulation.

Accessed from the Sync Manager, Machine Simulation provides visual verification and assurance that the interaction and syncing between operations perform exactly as you planned. Validate against potential collisions and track cycle time estimates to achieve maximum efficiency.

Avoid mistakes. Save time and money.

All machine components, workholding, stock, tools, and parts are simulated from the safety of your desktop, ensuring a safe and secure machining experience. You can identify potential collisions, see your cutting motion, and explore ways to optimize your processes with simulation. View all streams and statistics of the entire machining process with the capability to jump to any point in the process with the click of a button.

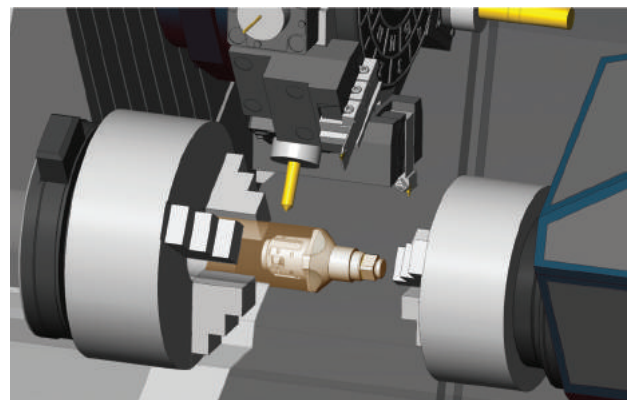

Get the most from your machine with multistation and half-index tool support.

Contact a local Mastercam expert at Mastercam.com/Resellers